

Side View 1

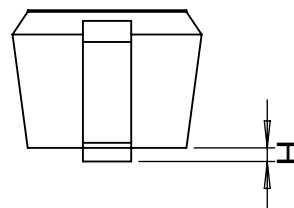

Side View 2

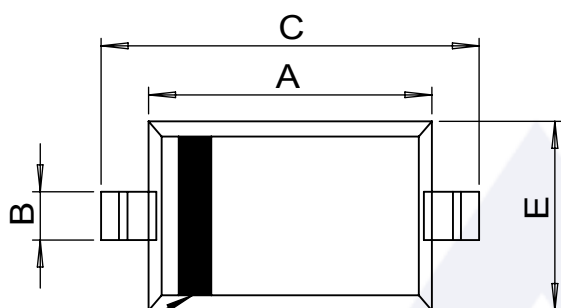

Cathode Band

(For Unidirectional products only)

Top View

Symbol	Dimensions in mm			Dimensions in Inches		
	Min.	Typ.	Max.	Min.	Typ.	Max.
A	1.600	1.700	1.800	0.063	0.067	0.071
B	0.250	0.320	0.400	0.010	0.013	0.016
C	2.300	2.600	2.800	0.091	0.102	0.110
D	0.800	0.950	1.100	0.031	0.037	0.043
E	1.200	1.300	1.400	0.047	0.051	0.055
F	0.080	0.130	0.180	0.003	0.005	0.007
L	-	0.475 REF.	-	-	0.019 REF.	-
L1	0.250	0.330	0.400	0.010	0.013	0.016
H	0.000	0.060	0.140	0.000	0.002	0.006

Package Name	Revision	First Angle Projection	Reference			
			IEC	JEDEC	JEITA	-
SOD323 (Type C)	Ver. M02 2024.05.30					